

DUAL TIME FEATURE

- The analogue and digital watch movements work independently and use separate battery power.

ANALOGUE TIME

- Pull out winder to set time, then push back in.

THE LIGHT FEATURE

- The light can be activated by gently pressing the button B on the side of the watch case once. The light has a 5 second time delay after which it automatically switches off.
- Battery life expectancy is 1 year, if the light is used 3 times daily.

THE COMPASS FEATURE

- The watch case must be held flat and not tilted or held upright.
- The compass is a design feature and not a highly accurate instrument. Accuracy will be affected by external surroundings.

THERMOMETER FEATURE

- Measures atmospheric temperature in degrees centigrade.

STORM

LONDON

NAVIGATOR

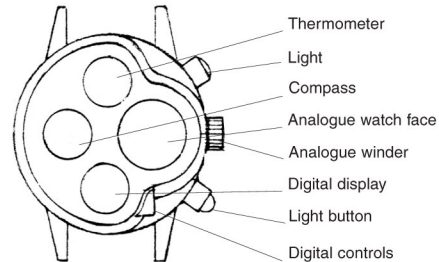

- Visual representations may differ from actual watchcase.

NAVIGATOR FEATURES

- The Navigator has a compass, thermometer and light feature.
- Dual time feature with analogue and digital mechanisms.
- Refer to 'Care and Maintenance' leaflet for recommended use and maintenance of your watch.

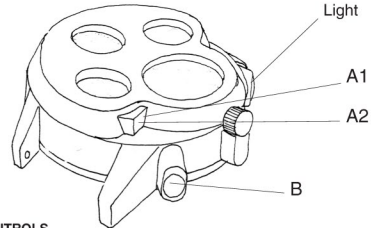

DIGITAL CONTROLS

- The digital display alternates between the time and date. The display changes every 3 seconds.
- To change the time or date settings press button A2 once to select each setting mode, and use button A1 to advance the digits. The setting sequence is as follows: MONTH : DATE : HOUR : MINUTES.
- When the setting sequence is completed the display will show time function only. Now press button A2 once. The display will now alternate between time and date.
- The setting sequence is now complete.
- Please note when setting the hour the lower part of the display will show the letter A to indicate AM or P to indicate PM.